

# Universal Window Kit instructions

Thank you for choosing this Goldair product. This kit includes:

- Material Window Seal
- 8m Velcro Tape

Please keep these instructions in a safe place for future reference.

Install the window seal in a window where the air conditioner is used. Ensure the window is thoroughly cleaned and dry before installation.

Please refer to your portable air conditioner's user manual for instructions on how to operate the device and how to attach the hose.

## Applying the velcro tape

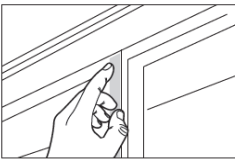

### Step 1

On a clean and dry window frame, attach the adhesive Velcro tape

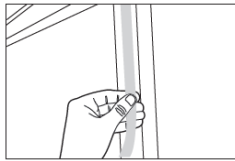

### Step 2

Install the self-adhesive Velcro tape all the way down to the bottom of the frame

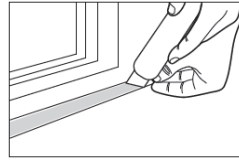

### Step 3

Cut the Velcro tape to size.

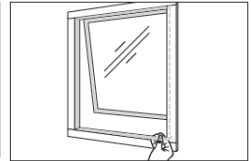

### Step 4

Repeat the same steps on the window

## Attaching the window seal

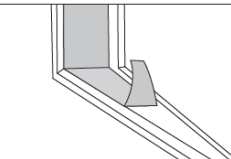

### Step 1

Attach the window seal to the Velcro tape you applied on the window and frame

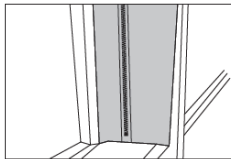

### Step 2

Ensure that both sides are aligned as you attach to the entire frame

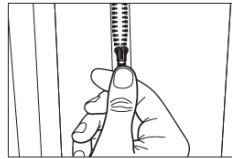

### Step 3

Unzip the window seal and insert the hose

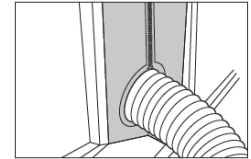

### Step 4

Zip up the seal to secure the hose in place

**You can cut the window seal to fit. Ensure you do not cut through the zip.**

# Goldair™

**Goldair – New Zealand**  
Monday – Friday 8am-5pm  
Phone +64 (0)9 917 4000  
Phone 0800 232 633  
info@cdb.co.nz

## SUPPORT AND TECHNICAL ADVICE

**Goldair – Australia**  
Monday – Friday 8am-5pm  
Phone +61 (0)3 9365 5100  
Phone 1300 465 324  
info@cdbgoldair.com.au